

FERRO KlassikPlus

THE BESTSELLER FOR SECURITY AND COMFORT.

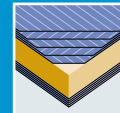

New:
upto 38 dB



5-ply faces



Exterior grade
MDF faces



Flat steel
stabilizer

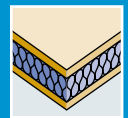

PU hard
foam core



Robust
construction

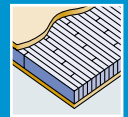

Laminated
core

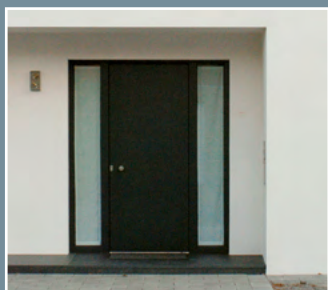

TECHNICAL DETAILS

1/8 DOOR FRAME			
1 Framing/timber	Finger-jointed and laminated timber framing.		
8 Flat steel stabilizer	Lock-side patented flat steel stabilizer – thermally separated and sound insulated – to absorb tractive and shearing forces. Flat iron straps are glued and friction-locked with the framework.		
Frame width/Options to shorten/Glass apertures	Thickness of door blank 68/78/88/98 mm		
	Frame width in mm	can be trimmed by	
	Top	155	110*
	Side	lock-side 70/hinge-side 155	lock-side 25*/hinge-side 110*
	Bottom	155	120*
Minimum distance for glass apertures on all 4 sides: 180 mm. The entrance width corresponds to the shortening dimension. When cut to minimum length at the bottom (120 mm), a single rebate (max. 18 mm) and/or fitting of drop down seal is possible.			
2 INNER LAYER			
Construction	Quality-proven with long-term experience - Sandwich construction of laminated core (spruce) and HCFC-free and environmentally compatible PU hard foam - Well surface stability through vertically aligned annual rings		
Bonding	Free of formaldehyde		
3-7 COVER BOARD			
Bonding	AW bonding according to DIN 68705 T2 temperature resistant up to 130° - 5 layers (noble veneer, longitudinal) - 3 layers (cross grained veneer) = can be veneered individually Full-surface bonding with the overall construction		
EXTERNAL DOOR BLANK			
Model/finish	Cut and sanded		

* with a max. rebate of 30 mm

EXAMINATIONS AND TESTS

LENGTH IN MM	2,110/2,240/2,470			
WIDTH IN MM	950/1,050/1,150			
THICKNESS IN MM	68	78	88	98
DIFFERENT CLIMATE TESTING				
DIN EN 1121 : 2000-09	test climate „c“			
DIN EN 1121 : 2000-09	test climate „d“			
DIN EN 1121 : 2000-09	test climate „e“			
TOLERANCE CLASSES (by using three hinges)				
DIN EN 12219 : 2000-6	3			
THERMAL TRANSFER COEFFICIENT				
U-value (W/m²K) according to EnEV	0,97	0,86	0,75	0,68
SOUND INSULATION				
DIN EN ISO 717-1 R _w ,[dB]	30/38*			
BURGLAR-RESISTANCE				
DIN ENV 1627 : 1999-04	RC2/RC3			
WEIGHT: 2,240 X 1,050 MM KG/PIECE	62	70	72	78

* model FERRO KlassikPlus Akustik on request



PRODUCT RANGE

FERRO KLASSIKPLUS – 68 MM / 78 MM / 88 MM / 98 MM							
Length in mm	2,110 (1,880*)		2,240 (2,010*)			2,470 (2,240*)	
Width in mm	950	1,050	950	1,050	1,150	1,050	1,150
Mahogany	▲	○	▲	○	▲	■	■
Okoume	▲	○	▲	○	▲	■	■
Meranti	▲	▲	▲	▲	▲	■	■
Oak	▲	○	▲	▲	▲	■	■
Pine	▲	▲	▲	▲	▲	■	■
Spruce	▲	▲	▲	▲	▲	■	■
Larch	▲	▲	▲	▲	▲	■	■
Paint-grade	○	○	▲	○	▲	○	■
MDF exterior	○	○	▲	○	▲	○	■
FERRO KLASSIKPLUS – 66 MM / 76 MM / 86 MM / 96 MM							
Length in mm	2,110 (1,880*)		2,240 (2,010*)			2,470 (2,240*)	
Width in mm	950	1,050	950	1,050	1,150	1,050	1,150
Cross grained PV	▲	○	▲	▲	▲	■	■

* minimal dimension ■ order-based production ○ in stock up to 68 mm ▲ available in 5 working days PV = peeled veneer face

All veneer surfaces = slices veneer or fine-line

Further dimensions, sizes and facings on request.



Any Questions? Info-Hotline: +49 8026 92538-11 www.moralt-ag.com
Moralt AG, Obere Tiefenbachstraße 1, 83734 Hausham, Phone: +49 8026 92538-0, Fax: +49 8026 92538-40, E-Mail: info@moralt-ag.de

This information is according to the present state of knowledge and does not represent an assurance of properties. Existing laws and regulations are to be followed by the recipient of our products at his own responsibility. All information refers solely to products by Moralt AG.

FERRO KlassikPlus

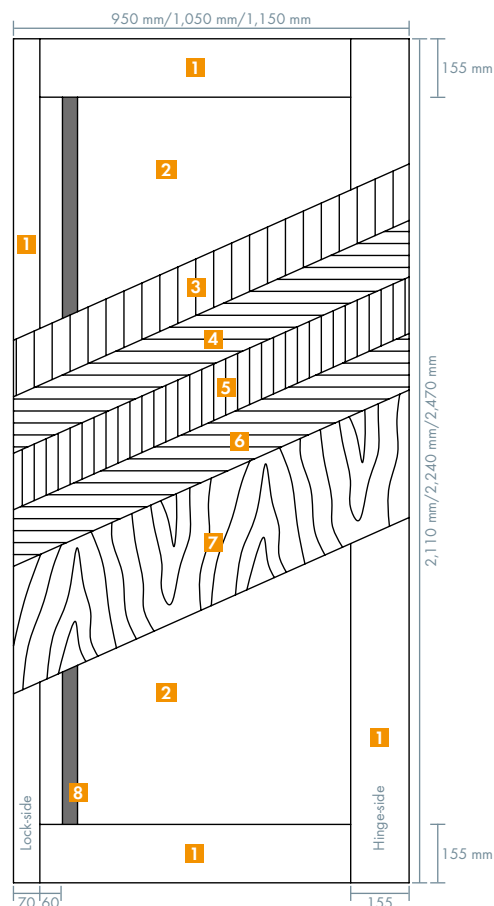

- 1** Framing/timber
- 2** Inner core layer in sandwich system/PU
- 3-7** Cover board
- 8** Flat steel stabilizer
- 9** PU hard foam

Cross-section view lock-side

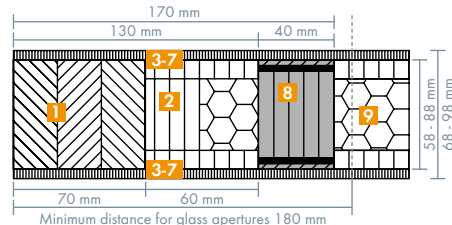

Cross-section view hinge side

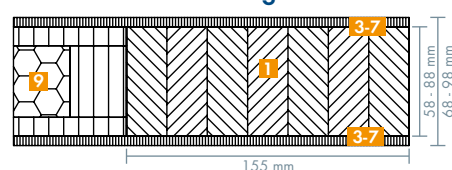

Despatch of single cargo

Direct delivery of a single piece to the manufacturer is possible.

CNC-processing service

All types may be delivered CNC processed.

Profi-Net timber distributor